

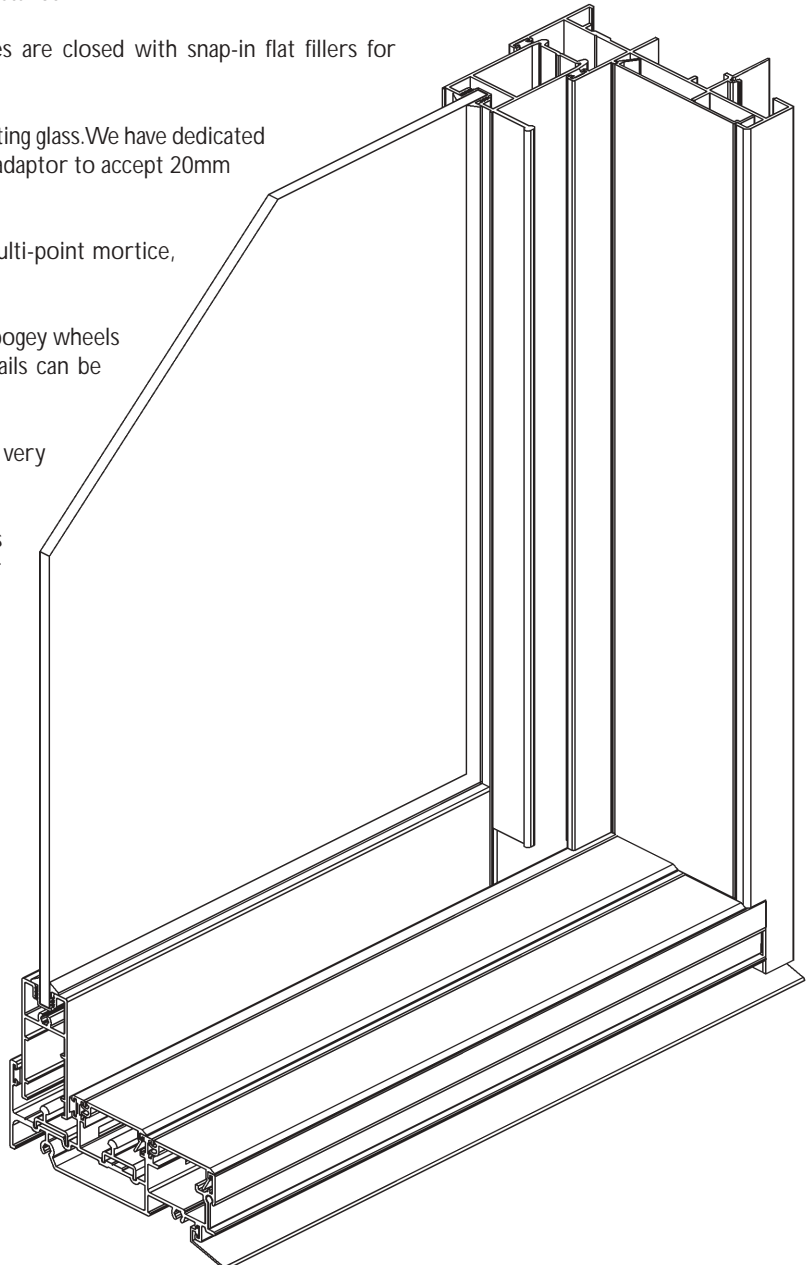

Design Features

1. High water resistance of 300Pa allows these doors to be installed into most residential projects.
2. Can be fabricated as 'XXF', 'FXX', 'FXXXXF', 'XF', 'FX', 'FXF', 'XFF', 'FFX' and 'FXXF'.
3. The accompanying optional stacking multi panel external flydoor system is snapped to the main frame. This applied flydoor system may not be required on high rise apartments.
4. The 108.60mm wide perimeter frame will couple to a large variety of Vantage adaptors :
 - 180° Door to window vertical coupler.
 - 135° Door to window bay coupler.
 - 90° Door to window bay coupler.
 - Door highlight couplers.
5. Flat external fillers creates a clean closed off frame appearance. On the sill the infills guide water away from the door panels and improve water resistance.
6. Unused internal and external frame recesses are closed with snap-in flat fillers for improved appearance.
7. Door panels can be glazed with thick or insulating glass. We have dedicated stiles for glass up to 16mm thick and an inlay adaptor to accept 20mm Insulating glass units.
8. We offer a large variety of locks including multi-point mortice, go to our web site to see the locks available.
9. Heavy door panels can be fitted with double bogey wheels for smooth long term operation. Running rails can be replaced in the future if necessary.
10. Can be fitted into commercial type sub-sill for very high water resistance.
11. Flydoors are fitted with snap-on interlocks again for improved appearance and labour saving.
12. WERS (Window Energy Rated System) tables are in section 04. Sound reduction ratings can be found in section 55.
13. For higher performance or very large size doors check out 'SlideMASTER' Series 702 or 704, refer AWS Commercial.



Australian Registered Design

Most of the features on this product can be seen in full colour on our web site:
www.vantagealuminium.com.au

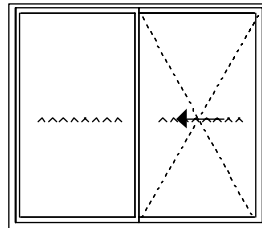
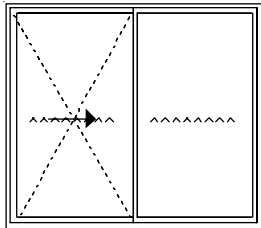

Type 'XF' & 'FX'

Single track door

Maximum height = 2400mm
 Maximum width = 2710mm

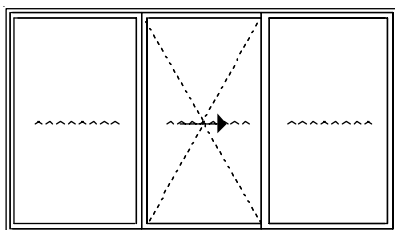

Type 'FXF', 'FFX' & 'XFF'

Single track door

Maximum height = 2400mm
 Maximum width = 4000mm

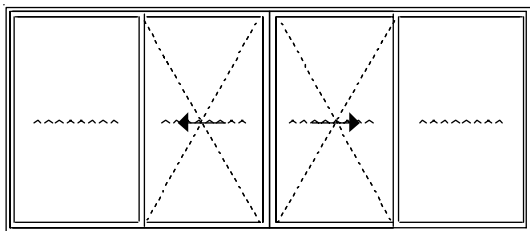

Type 'FXXF'

Single track door

Maximum height = 2400mm
 Maximum width = 5300mm

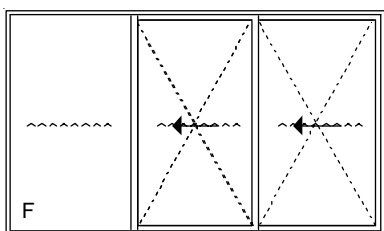

Type 'FXX' & 'XXF'

Dual track door

Maximum height = 2400mm
 Maximum width = 4000mm

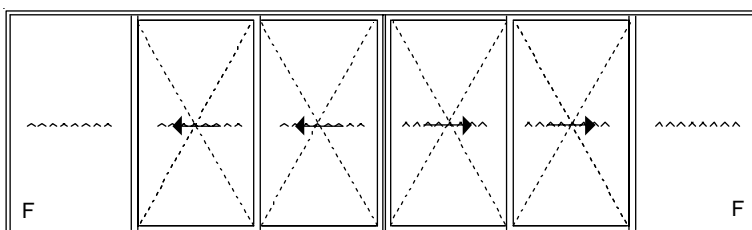

Type 'FXXXXF'

Dual track door

Maximum height = 2400mm
 Maximum width = 6000mm

Overheight Doors

We can fabricate this door up to 2700mm high depending on the wind load area. Refer Specifiers Manual for more detailed ratings tables.



Architectural Information

Page: **75.3**

Series 542 DStacker™ Sliding Door

Date: May 06

Vertical Cross Section

Replaces: Mar 04

Scale: Not to scale

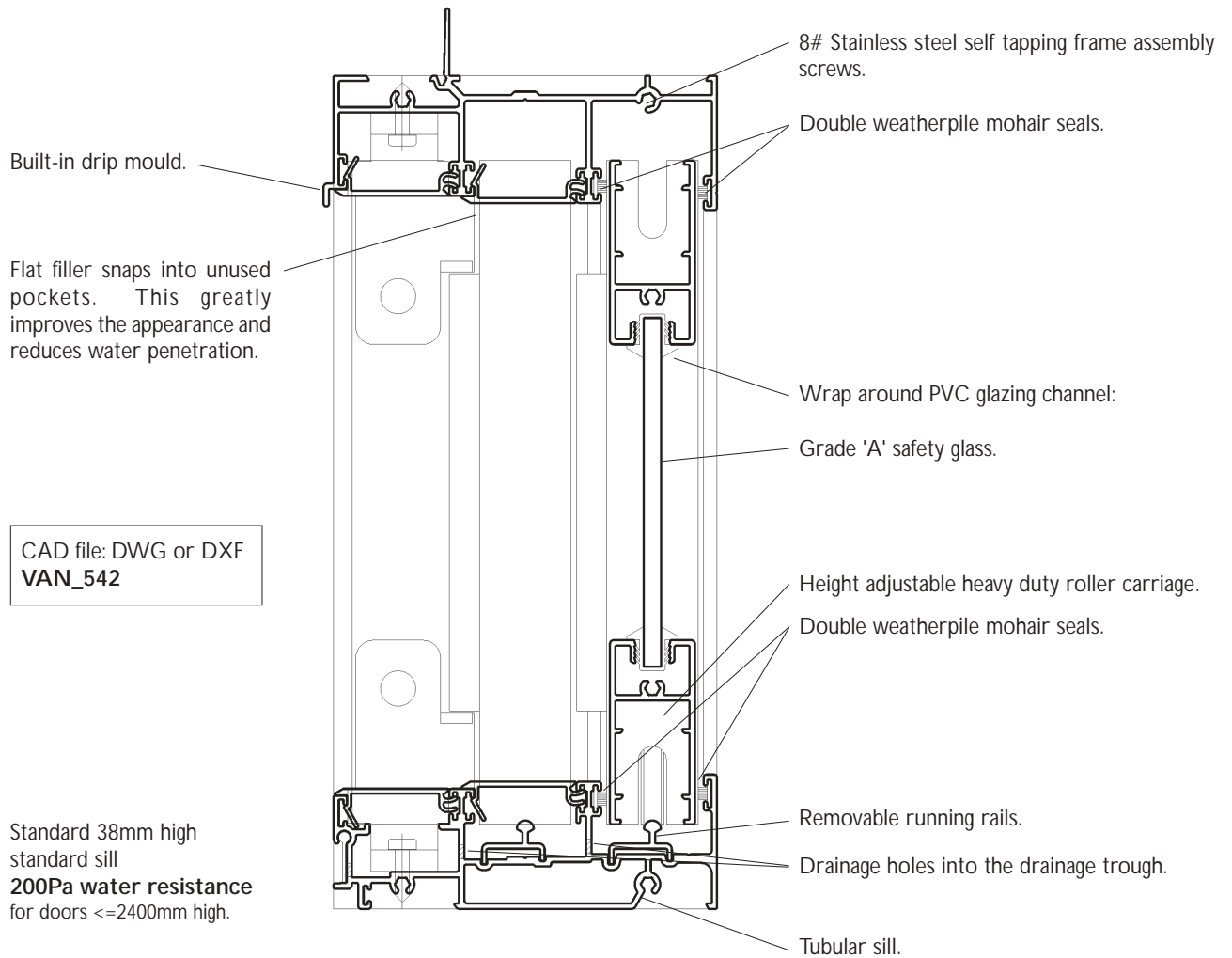

CAD file: DWG or DXF
VAN_542

Standard 38mm high standard sill
200Pa water resistance
for doors <=2400mm high.

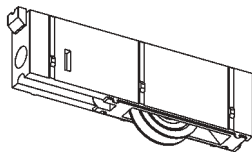

38mm dia. nylon, tyred ball bearing, height adjustable wheel carriage.
For heavier doors we fit double bogey wheel carriages.

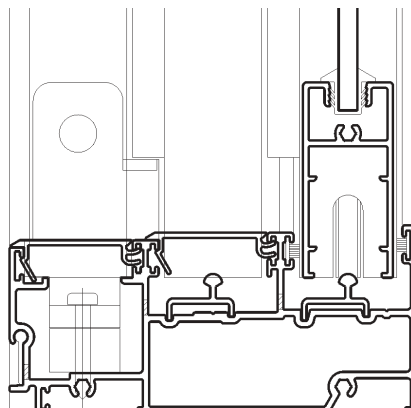
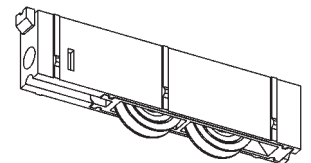

Special 50mm high performance sill
300Pa water resistance
for doors <=2400mm high.

200Pa water resistance
for doors >2400mm high.

Recess the floor.
We always recommend that DStacker™ door sills are recessed into the floor slab.

Architectural Information

Series 542 DStacker™ Sliding Door

Horizontal Section through 'FXX' Multi Panel Door

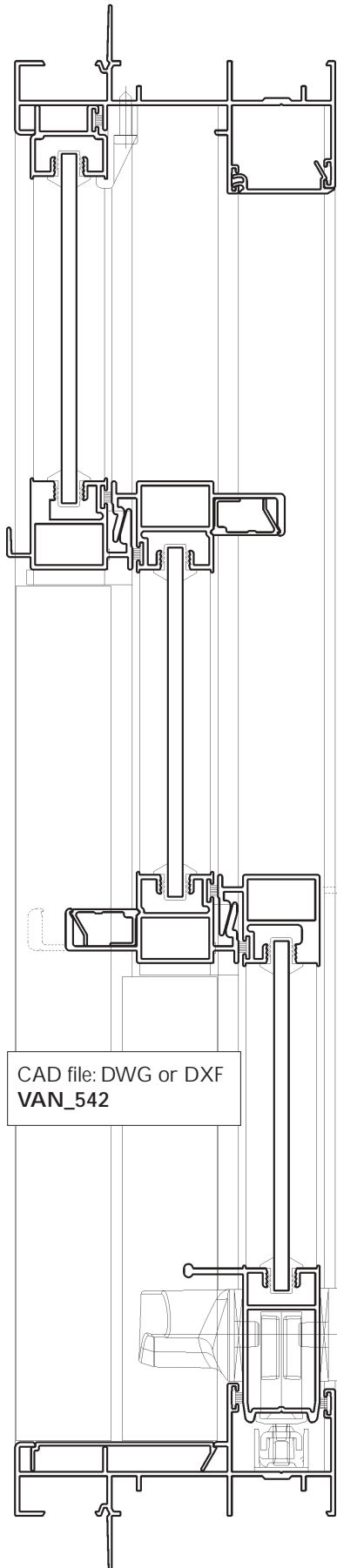

CAD file: DWG or DXF
VAN_542

Meeting Stile Strength

This table shows a range of serviceability ratings (1/150) that can be achieved:

type code	Height mm	Width mm	Meeting Stiles		
			Light	Medium	Heavy
FXX	2100	3200	577 Pa	886 Pa	1691 Pa
FXX	2100	3400	548 Pa	842 Pa	1608 Pa
FXX	2100	3600	524 Pa	805 Pa	1537 Pa
FXX	2100	3800	503 Pa	772 Pa	1475 Pa
FXX	2100	4000		744 Pa	1421 Pa

The door has been successfully tested to 300Pa water resistance. This makes the product suitable for most residential applications.

For ratings on other sizes and types contact your local Vantage fabricator.

Alternative locks :

ANDO™ surface mounted single point deadlock.

ANDO™ surface mounted two point deadlock.

'Albany' mortice deadlocks two point deadlock.

Lock colours:

All of these locks come in a variety of standard powder coat finishes. Locks can also be supplied in a variety of metal finishes refer your local Vantage sales office or go to our web site.

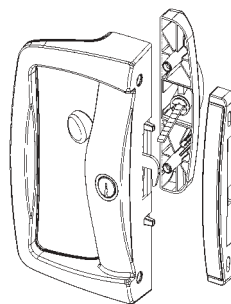

Single point locking

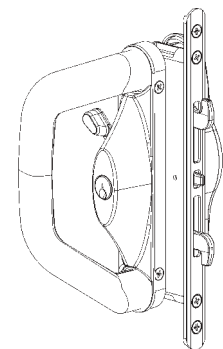

Albany mortice two point locking

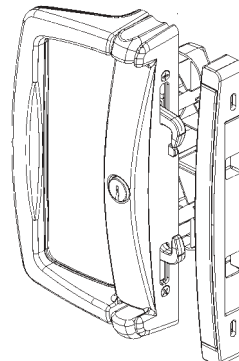

ANDO™ two point locking

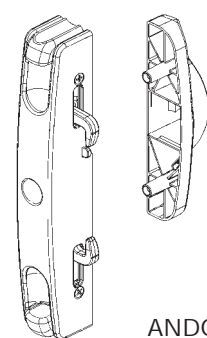

ANDO™ two point slimline locking





Architectural Information

Series 542 DStacker™ Sliding Door

'FXX' Multi Panel Door in the Open Position

Page: 75.5

Date: Mar 04

Replaces:

Scale: Not to scale

Important Feature

Light and medium meeting stile combinations don't project inside past the frame line.

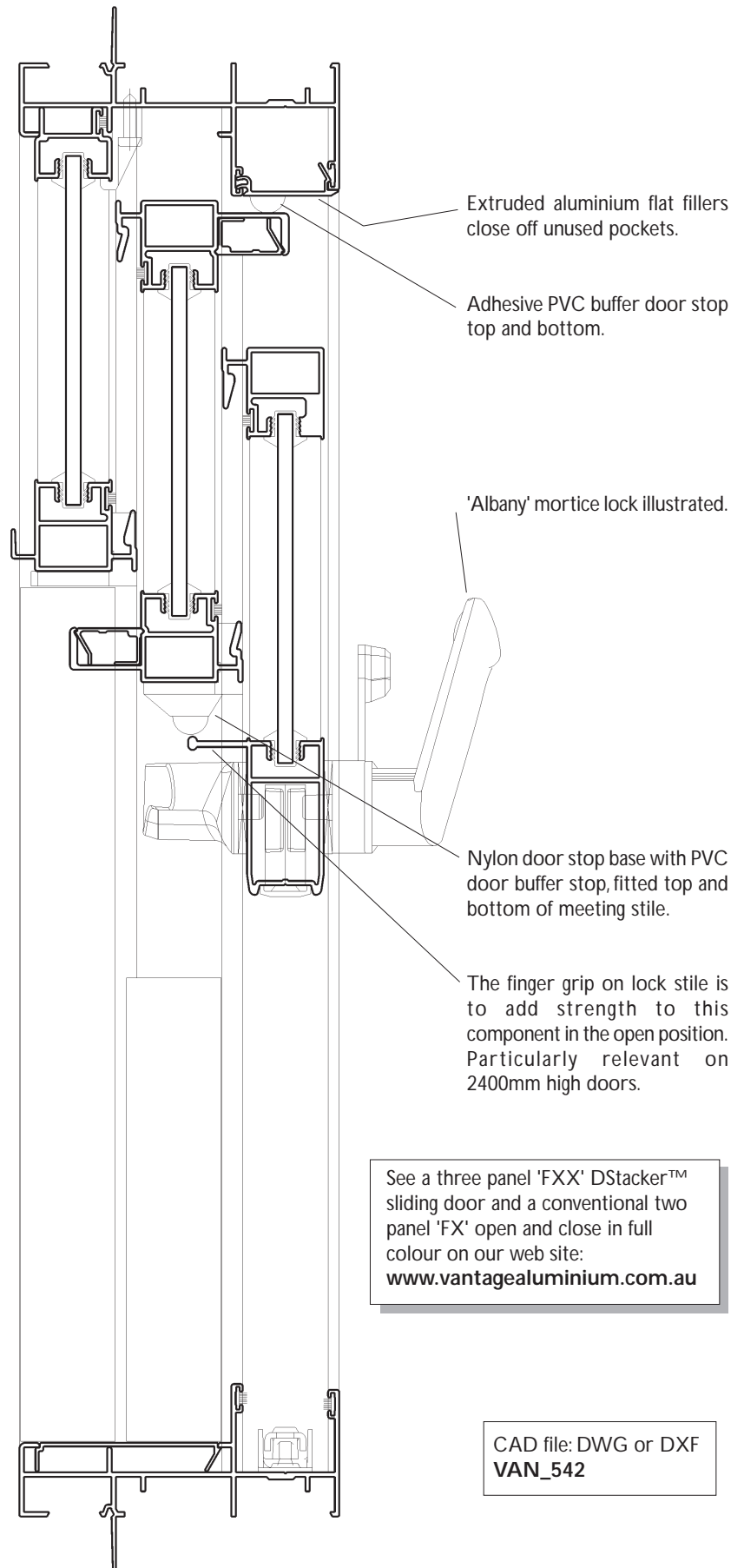

18mm Gap to protect fingers as doors are opened.

Finger grip on lock stile clashes with top and bottom buffer stops.

Clear opening on 'FXX' door: approx. 60% of O/A width

See a three panel 'FXX' DStacker™ sliding door and a conventional two panel 'FX' open and close in full colour on our web site:
www.vantagealuminium.com.au

CAD file: DWG or DXF
VAN_542

Architectural Information

Series 542 DStacker™ Sliding Door

Snap-on 'FXX' Multi Panel Flydoor

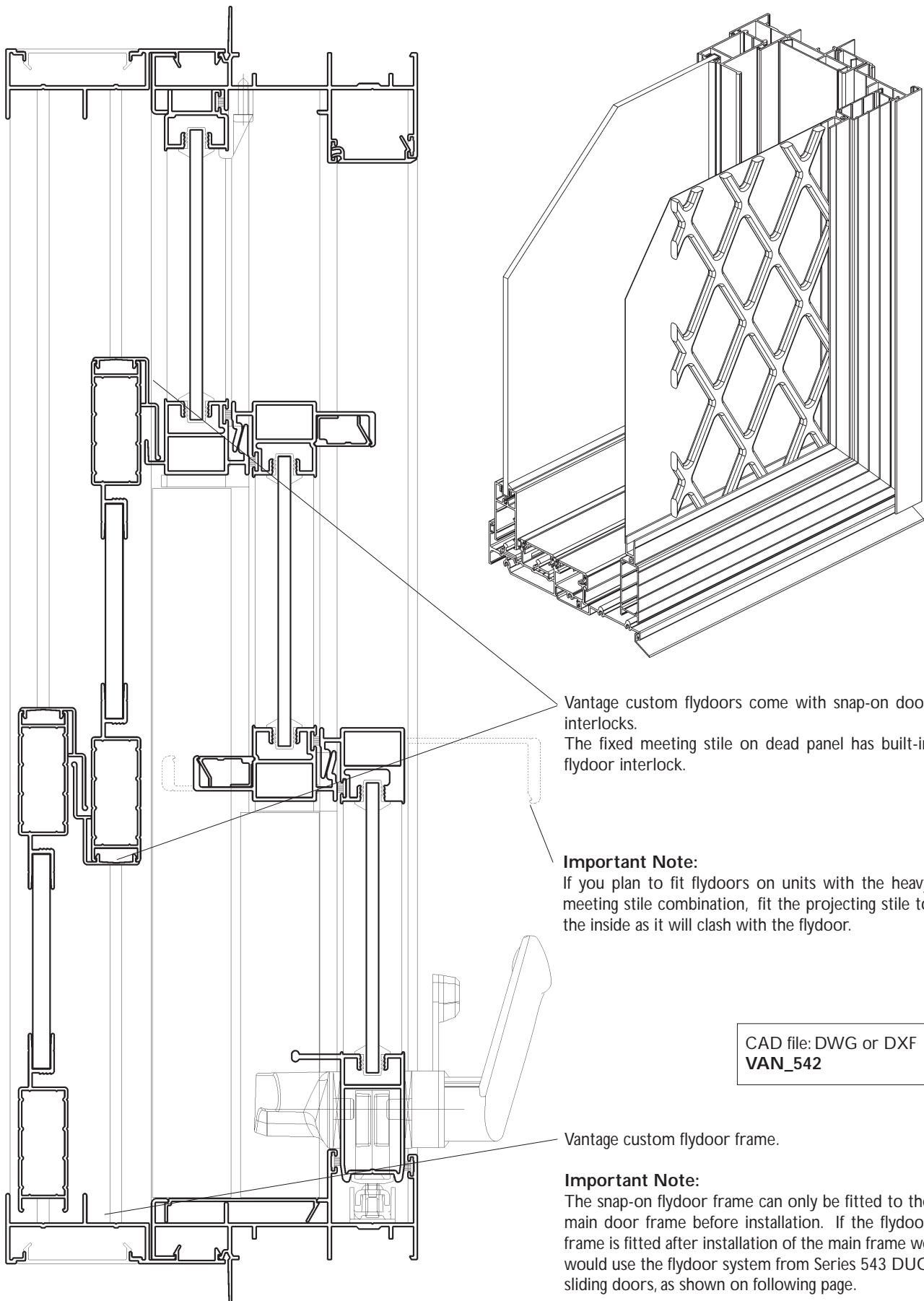



Architectural Information

Series 542 DStacker™ Sliding Door

Retro-fit 'FXX' Multi Panel Flydoor

Page: 75.7

Date: Mar 04

Replaces:

Scale: Not to scale

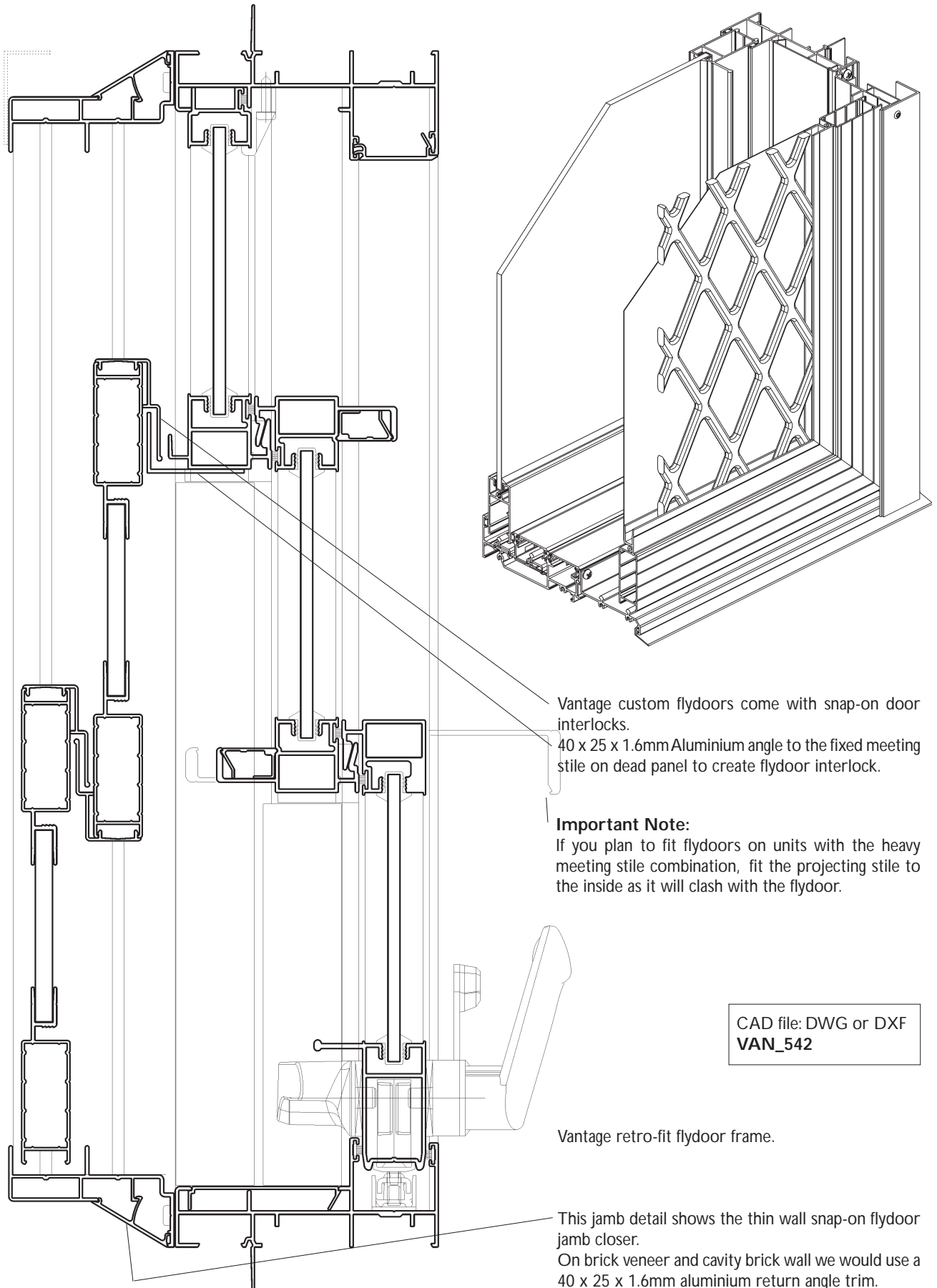

Page: 75.8
 Date: May 06
 Replaces: Mar 04
 Scale: Half full size

Architectural Information

Series 542 DStacker™ Sliding Door

Alternative Sub-sill Installation

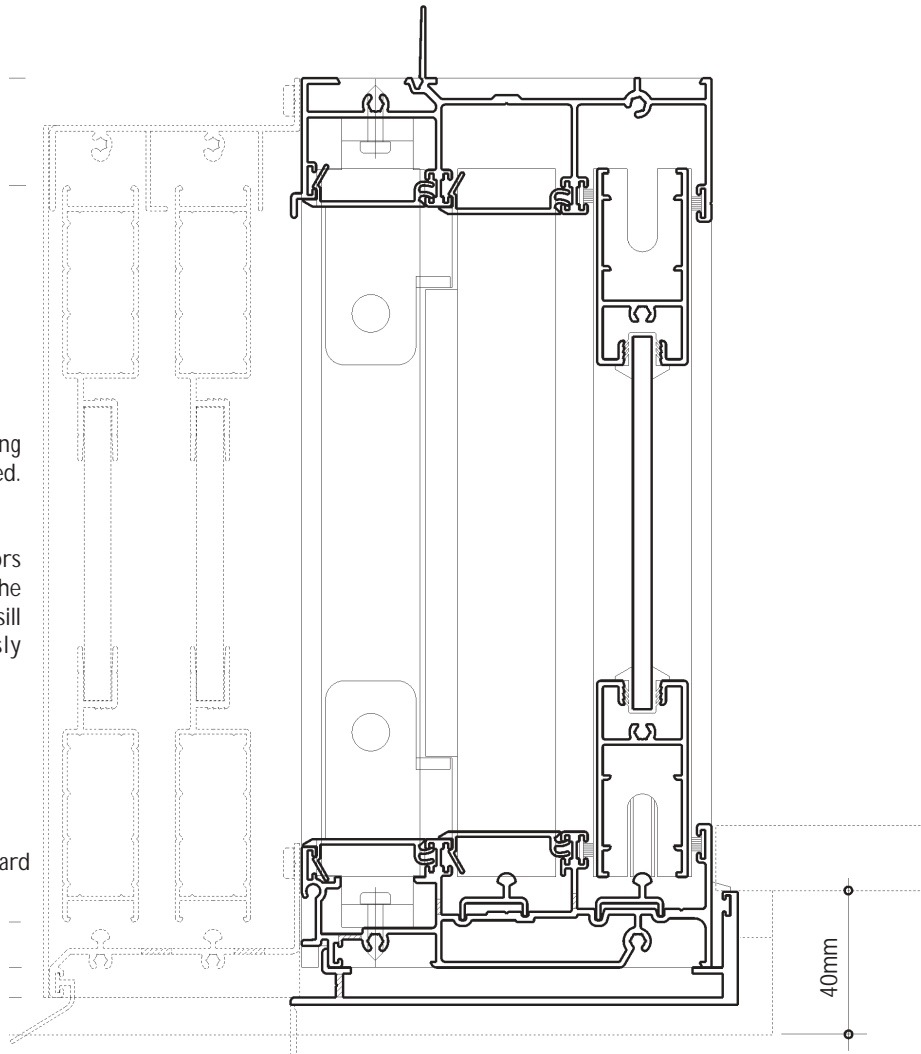

Optional retro-fit stacking flydoor system shown dotted.

Note:
 To ensure that the flydoors stay in place (in the frame), the underside of the flydoor sill should be continuously supported.

Standard 38mm high standard sill into sub-sill
300Pa water resistance
 for doors <=2400mm high.

40mm

On retro-fit flydoor sill, the location will vary depending on sill finish and location and splay in the external sill bricks/tiles.
 Flydoor height will need to be site checked.

This detail shows how the sub-sill could be cut down to suit a flat sill detail.

CAD file: DWG or DXF
VAN_542

Standard 50mm high performance sill into sub-sill
300Pa water resistance
 for doors <=2700mm high.

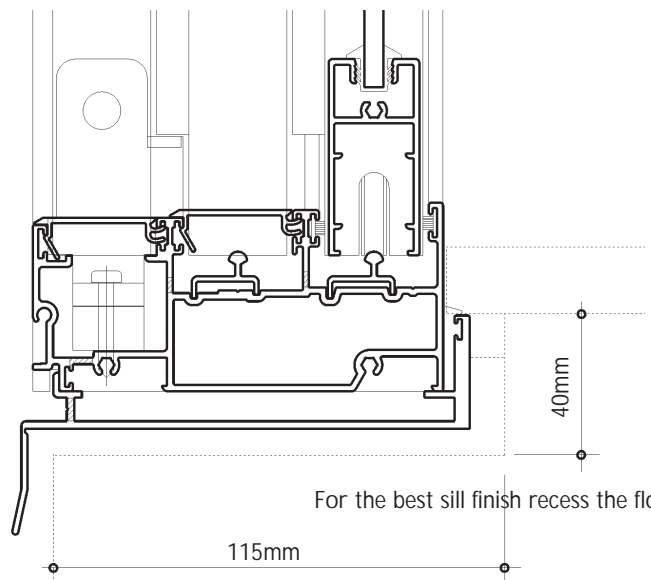

40mm

115mm

For the best sill finish recess the floor slab.



Alternative Sliding Door

Date: May 06

High Performance Commercial Stacking Sliding Door

Replaces: Mar 04

Scale: Not to scale

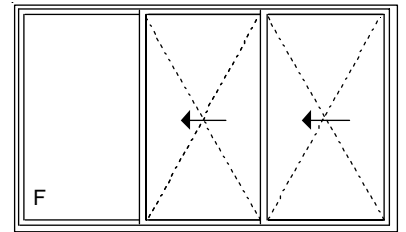
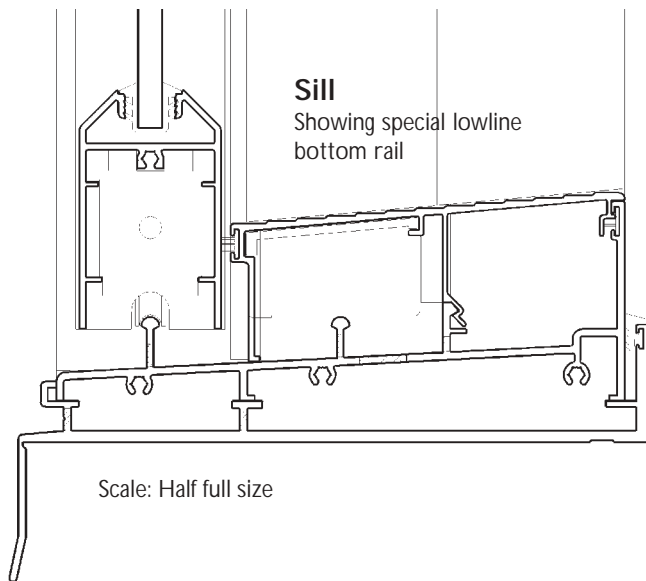

Alternative Commercial Sliding Door

If you are looking for a stronger, higher performance, bolder sliding door consider the AWS SlideMASTER™ Series 702.

Features overview:

- 150mm Frame width.
- Can be fabricated as 'XXF' and 'FXXXXF' stacking doors.
- Very high water resistance.
- Stronger panels allow door heights up to 3000mm.
- Compatible with AWS FrontGLAZE™ shopfront framing.

Refer AWS Commercial Specifier Manual for more details.
Coloured animated images can be seen on AWS web site:
awscommercial.com.au

Australian Registered Design.

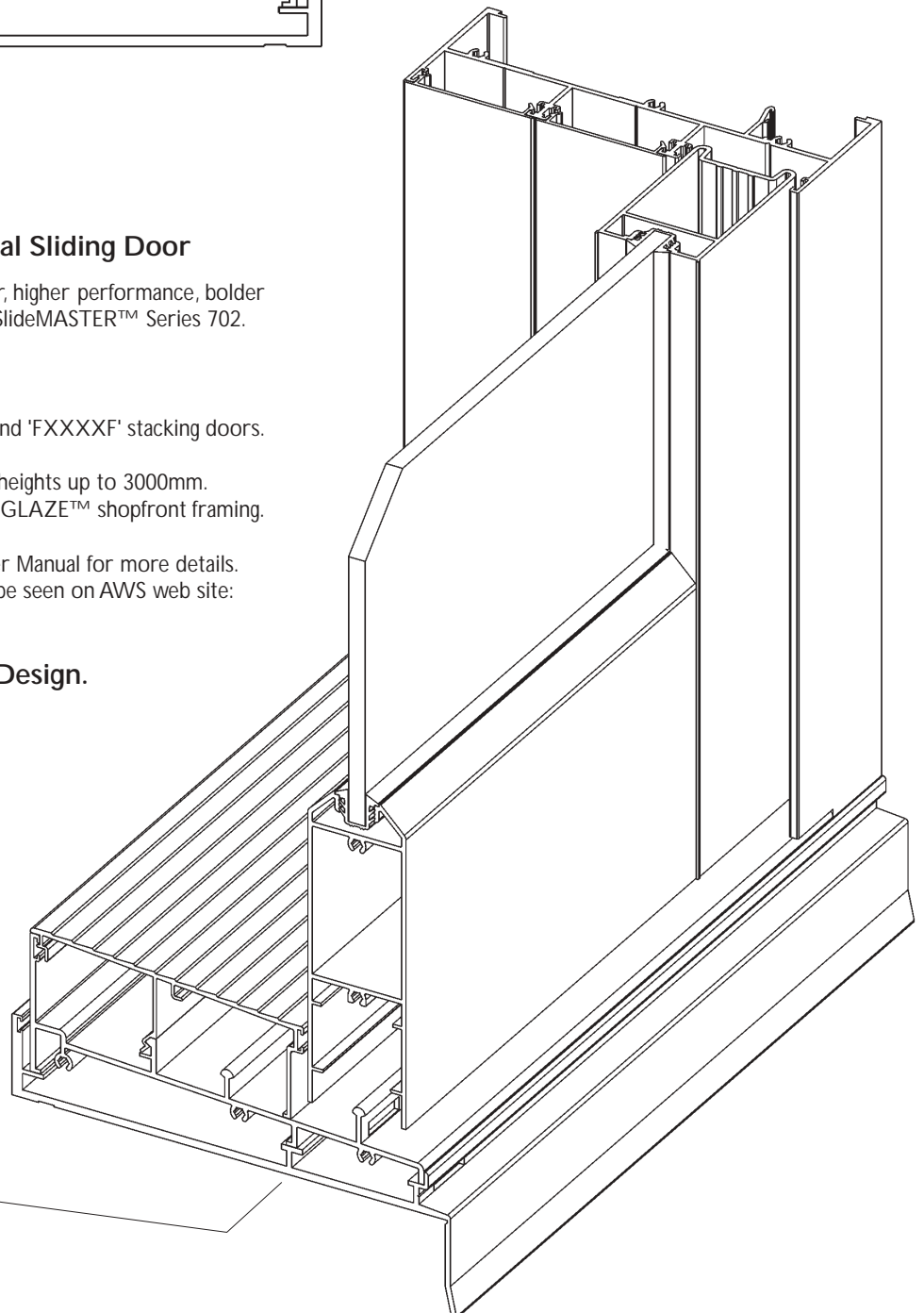

Another feature:
The sub-sill under 150mm frame has an additional support at mid span to support the middle door panel.

Scale: Not to scale

Architectural Information

Alternative Sliding Door

Architectural Commercial Stacking Sliding Door

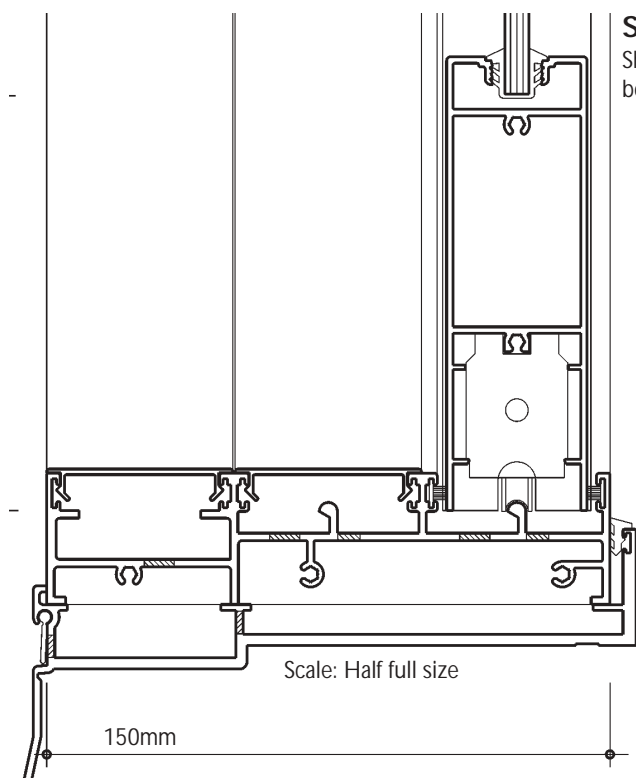

Sill

Showing special lowline bottom rail

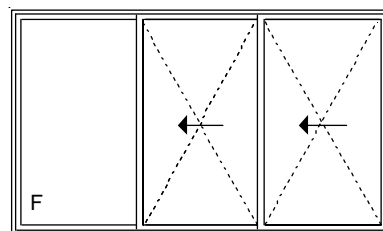

Alternative Architectural Commercial Sliding Door

If you are looking for a stronger, bolder sliding door consider the AWS SlideMASTER™ Series 704.

Features overview:

- 150mm Frame width.
- Can be fabricated as 'XXF' and 'FXXXXF' stacking doors.
- Very high water resistance.
- Stronger panels allow door heights up to 3000mm.
- Compatible with AWS FrontGLAZE™ shopfront framing.

Refer AWS Commercial Specifier Manual for more details. Coloured animated images can be seen on AWS web site: awscommercial.com.au

Australian Registered Design.

Another feature:

The sub-sill under 150mm frame has an additional support at mid span to support the middle door panel.

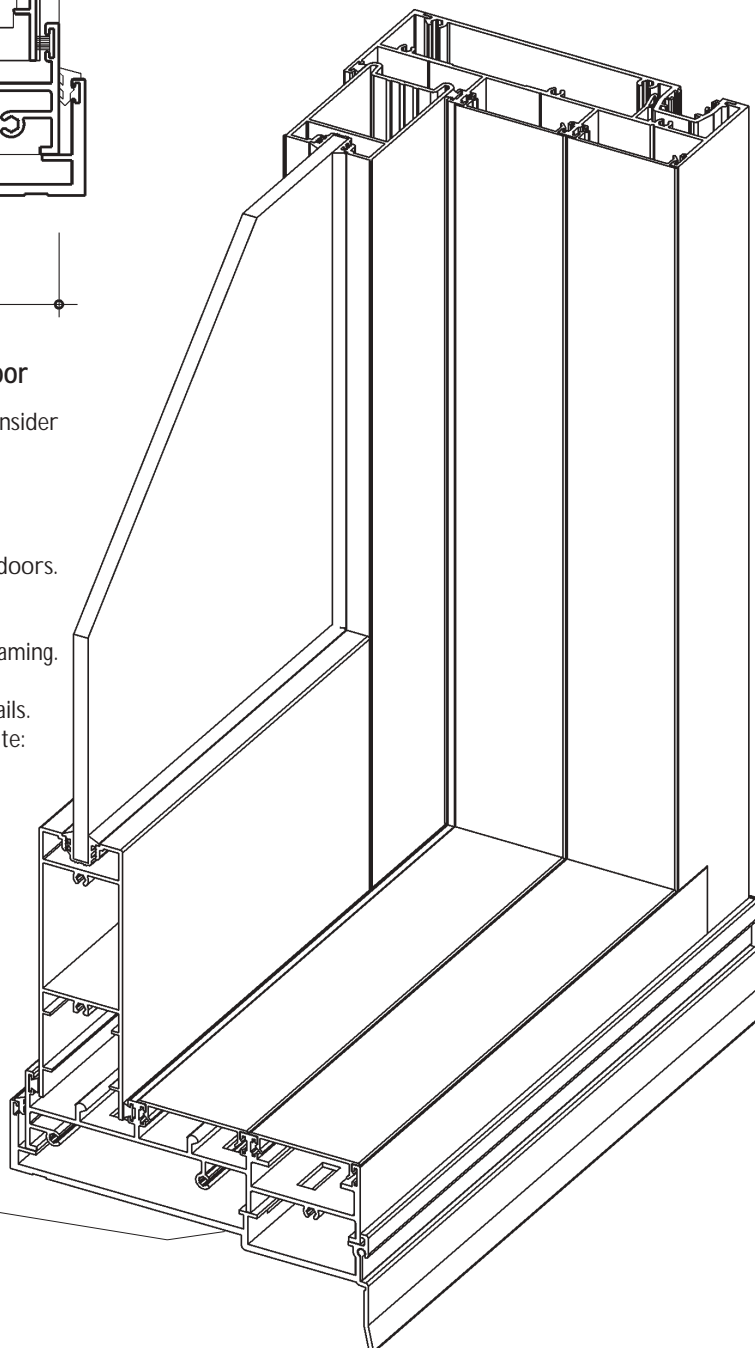

Scale: Not to scale



Architectural Information

Series 542 DStacker™ Sliding Door

Index

Page: **75.0**
Date: Mar 04
Replaces:
Scale:

Page	Contents
75.1	Introduction.
75.2	Standard configurations.
75.3	Vertical cross section.
75.4	Horizontal section through 'FXX' multi panel door.
75.5	'FXX' Multi panel door in the open position.
75.6	Snap-on 'FXX' multi panel flydoor.
75.7	Retro-fit 'FXX' multi panel flydoor.
75.8	Alternative sub-sill installation.
75.9	Alternative high performance sliding door.
75.10	Alternative high performance sliding door.

Series 542 DStacker™ Sliding door internal view
(Not to scale)

