

## Design Features

1. Successfully tested for compliance with Australian Standard AS 2047.
2. Optional meeting stile strengths cover a large variety of design wind load areas.
3. The meeting stiles have been designed to withstand wind loads, and equally important the lock stile has enough body strength to carry the lock and not flex excessively while opening and closing the door.
4. Two heavy duty sill options - One for standard water performance and a tall sump type sill for very high water performance.
5. Low line nursing home sill option, shown later in these notes.
6. Flydoors slide on the outside and run on large diameter wheels.
7. Glass door external meeting stile has built-in interlock to accept the flydoor interlock.
8. The glass door and flydoor rolling tracks are protected from accidental damage by the splayed threshold.
9. Panels can be re-handed on site (slide direction reversed).
10. Door panels can be glazed with thick or insulating glass units.
11. WERS (Window Energy Rated System) tables are in section 04. Sound reduction ratings can be found in section 55.

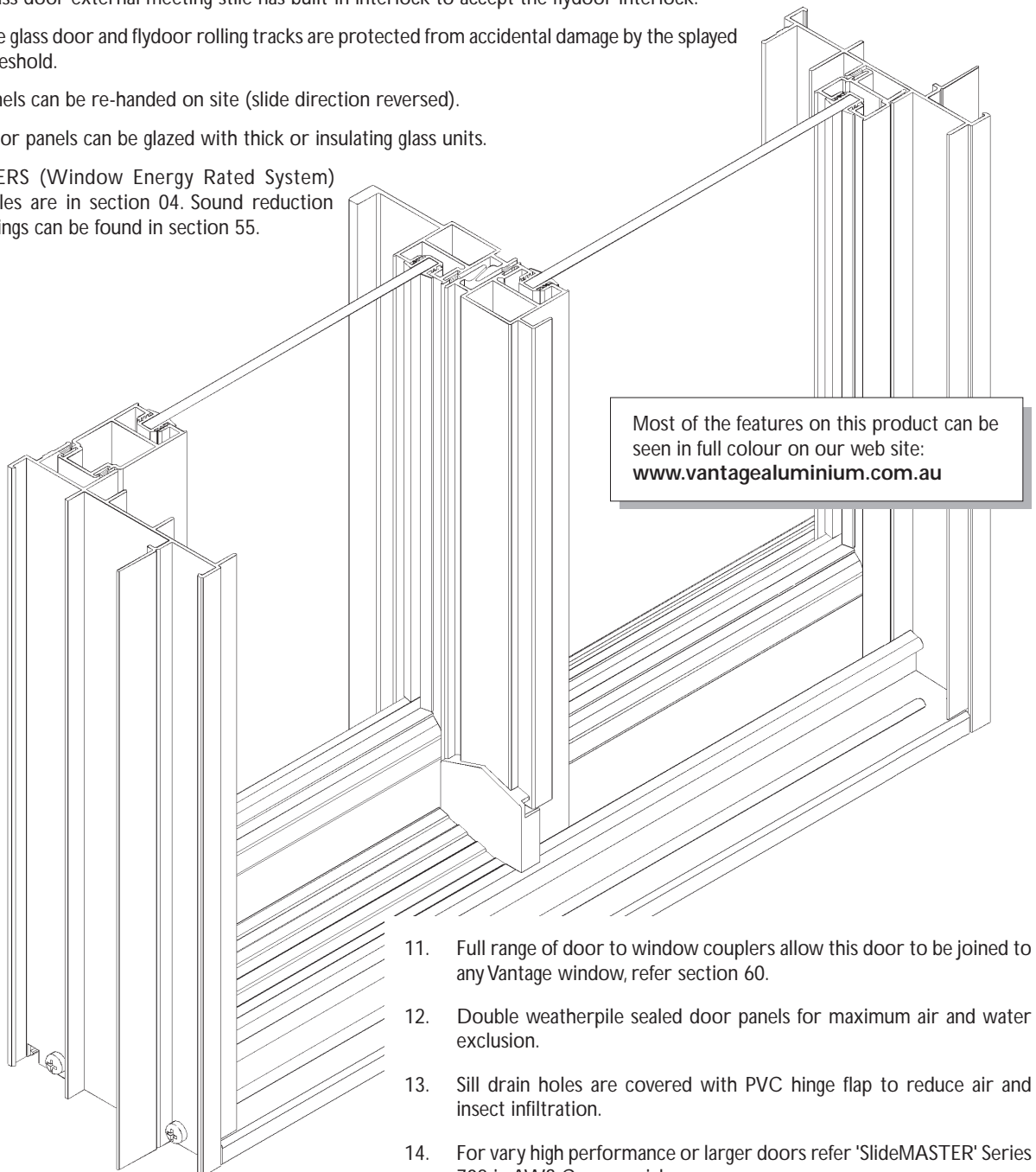

Page: 71.2  
Date: May 06  
Replaces: Oct 04  
Scale: Full size

# Architectural Information

## Series 541 Sliding Door

### Glazing Options

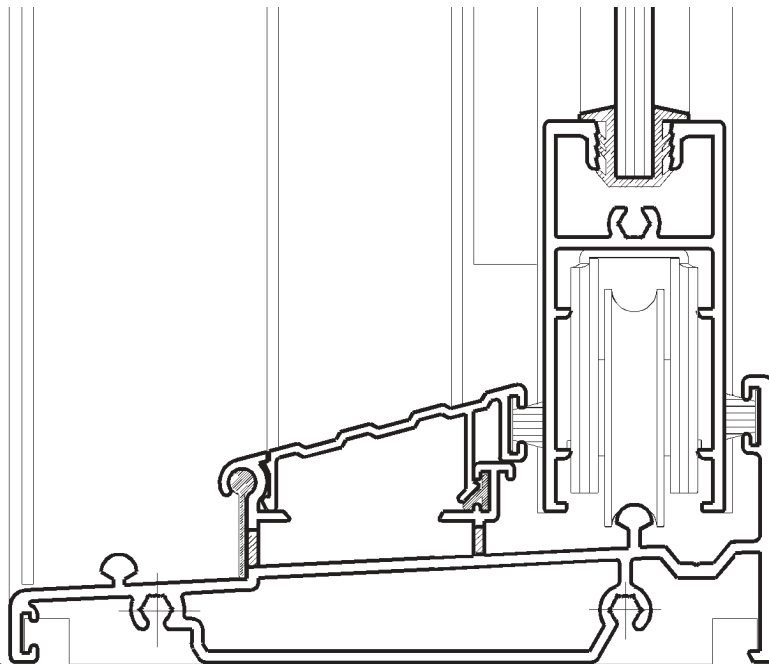

#### Standard

Aluminium door components wrap around the glass

This tubular sill has been designed to resist deflection as the doors are opened and closed.

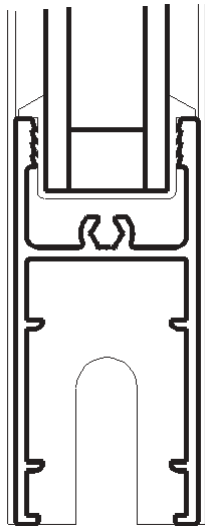

We have dedicated panel sections to accept:

**8.38mm Laminated**  
**10.38mm Laminated**

or

**16mm Double glazing**

as shown left

All of these heavy panels would be fitted with double bogey wheel as shown below.

#### 20mm Double Glazed

20mm Insulating glass panel inlay adaptor, door now runs on double bogey wheels (illustrated below).

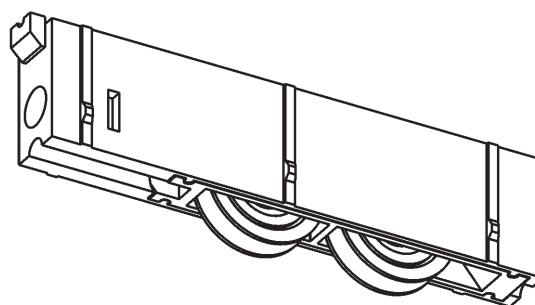
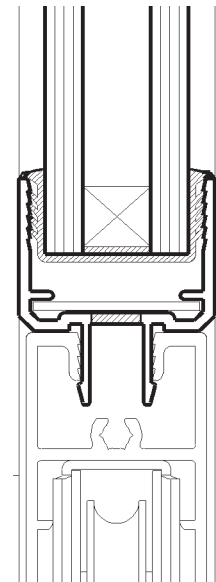



# Architectural Information

## Series 541 Sliding Door

### Check List

Page: 71.3

Date: Aug 03

Replaces:

Scale:

**Not all sliding doors are the same.** This is a product that will be opened and closed regularly and needs to perform, keep the elements on the outside and operate smoothly for years to come. Below is a list of the items you should check/compare when choosing your door.

### Features

### Vantage 541 Opposition

Does the door comply with the relevant Australian Standards. <ul style="list-style-type: none"><li>All doors should comply but it pays to ask for written proof.</li></ul>	Yes
Coastal installations can be upgraded to 300 Pa (high) water rating.	Yes
Direction of slide can easily be changed without major surgery. <ul style="list-style-type: none"><li>If the home owner should change their mind on the direction of slide after the doors are installed it's possible to easily re-hand the door.</li></ul>	Yes
Heavy duty tubular sill strong enough to carry wheel chairs and heavy door panels.	Yes
Industry standard hardware. <ul style="list-style-type: none"><li>Locks and wheels are readily available hardware items which can easily be sourced.</li><li>Heavy duty rollers matched to the wheel rail ensure maximum wear and silent running.</li></ul>	Yes
Very heavy door panels including double glazed can be fitted with double bogey wheels.	Yes
Flydoors run on the outside. <ul style="list-style-type: none"><li>The only purpose for a screen door is to keep insects on the outside, if the screen door is fitted inside the glass doors the insects will be in with you when you close the glass door.</li><li>Likewise if barrier type screen doors are on the inside you will have to open this barrier door to close the main glass door when you want to keep someone out, this completely defeats the purpose of having a barrier flydoor.</li></ul>	Yes
Interlock on trailing edge of barrier flydoors. <ul style="list-style-type: none"><li>When these barrier flydoors are closed and locked they should also be interlocked at the meeting stile to reduce the chance of them being pulled off the track.</li></ul>	Yes
Sliding door can be coupled to any Vantage window without visible rivets.	Yes
The sill drainage holes are covered. <ul style="list-style-type: none"><li>Many sliding doors leak a lot of air through the sill area either through open drain holes or poorly sealed doors.</li><li>A well sealed door will reduce heating and cooling costs.</li></ul>	Yes
Protected running tracks. <ul style="list-style-type: none"><li>A sliding door will only operate smoothly if the running rails are protected. If these rails get damaged by shoe scuffing the nylon wheel will deteriorate quickly then cause major damage to the frame.</li><li>This is the most common cause of sliding door failure and if left unattended usually results in the need for a completely new door unit to be installed.</li><li>Always keep the sill clean and protect the running rails - On the Series 541 door you will notice that both glass and flydoor rails are recessed for protection.</li></ul>	Yes
Double weatherpile. <ul style="list-style-type: none"><li>Our sliding door is double weatherpile all round to reduce air infiltration which in turn improves the water resistance.</li><li>Basically doors don't rattle if they have weatherpile both sides.</li></ul>	Yes
Rounded corner on the frame and sash members where ever possible. <ul style="list-style-type: none"><li>Modern paint finishes don't like sharp corners.</li></ul>	Yes

**These are what we see as the most important points to be checked - Compare us with the others.**

Page: 71.4  
Date: Aug 03  
Replaces:  
Scale: Full size

# Architectural Information

## Series 541 Sliding Door

Vertical Section through Opening Panel

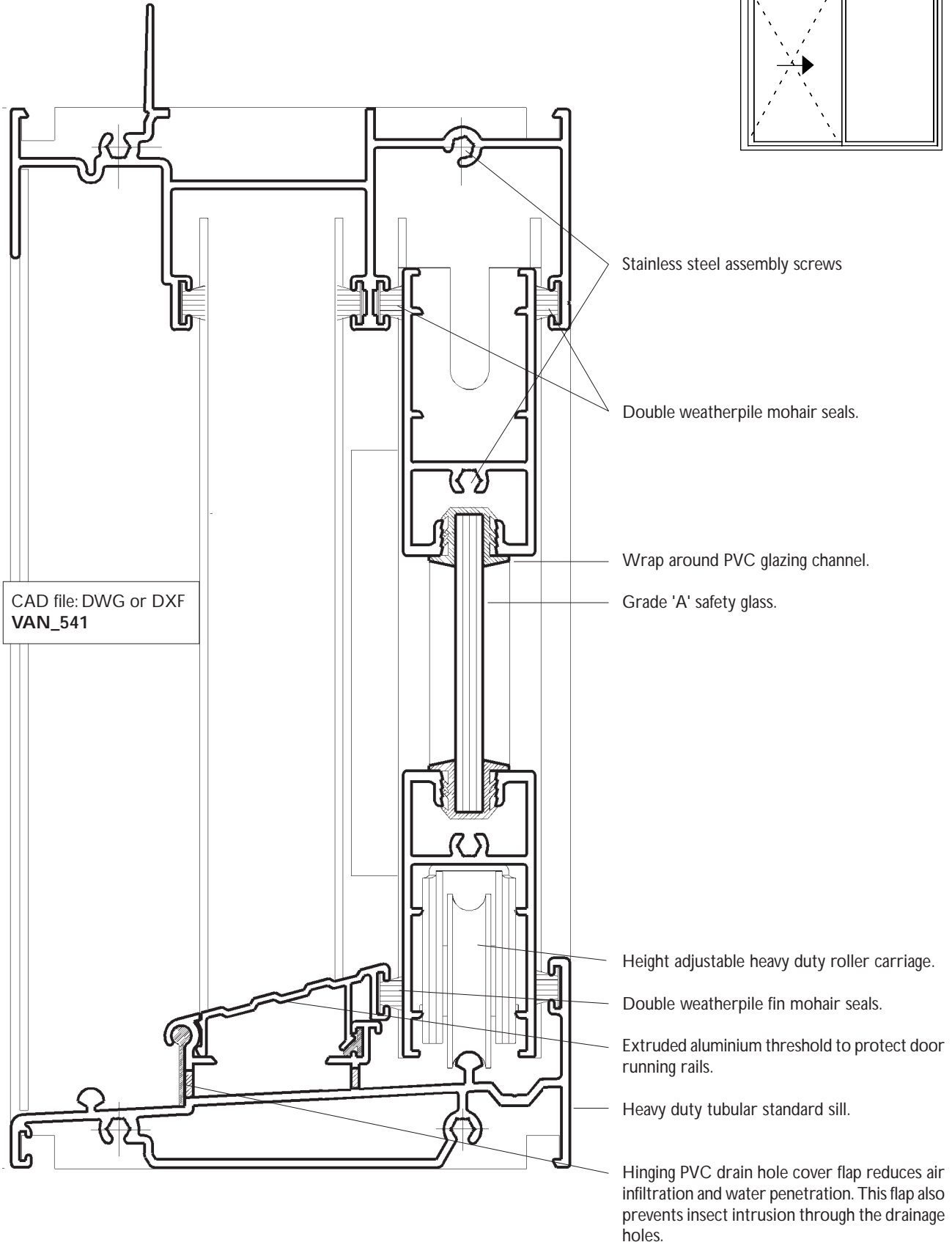
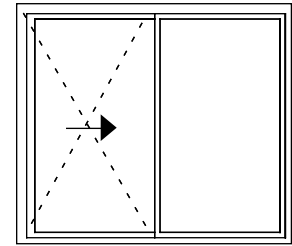

150 Pa Water rated sill



# Architectural Information

## Series 541 Sliding Door

High Performance Sill & Lock Options

Page: 71.5

Date: May 06

Replaces: Oct 04

Scale: Full size

### 300 Pa Water rated

#### Important Note:

This tubular high performance sill has an impact on the glass height as the sill is 12mm higher than the standard sill.

CAD file: DWG or DXF  
VAN\_541

Double weatherpile fin seal mohair seals.

Drainage holes.

When screwing down through the sill use this recess and seal the screw to the sill.

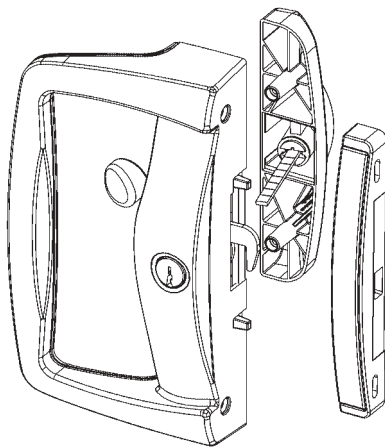
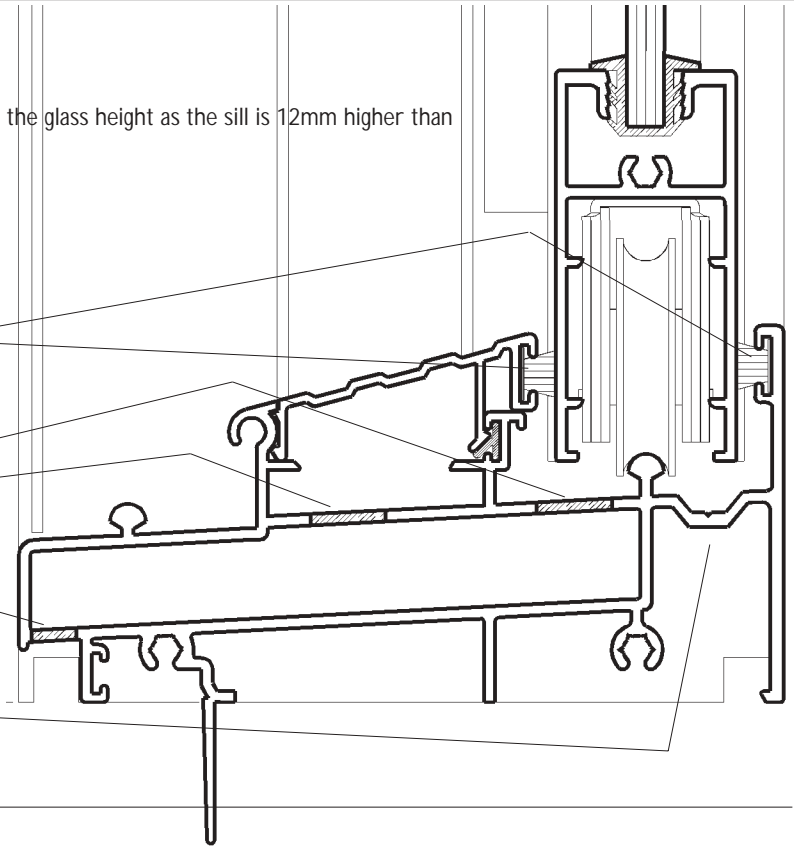

### Locking Options

#### Standard Vantage ANDO™ double cylinder single point deadlock

The standard colour for this lock is black, also available in standard and special colours to match the framing.



#### Alternative Vantage ANDO™ double cylinder two point deadlock

Available in standard painted colours and special colours, polished metal for that added feature and polished stainless steel for the ultimate finish.

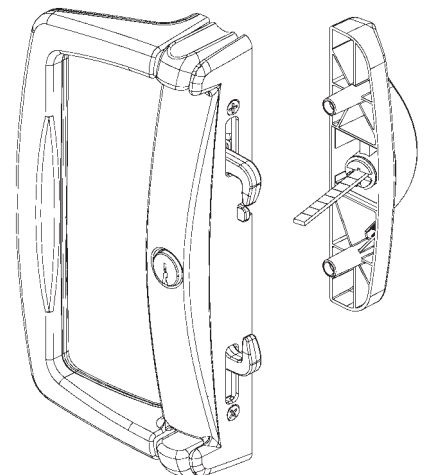

Both of these locks plus their features can be seen on our web site: [www.vantagealuminium.com.au](http://www.vantagealuminium.com.au)

Page: 71.6  
Date: Aug 03  
Replaces:  
Scale: Full size

# Architectural Information

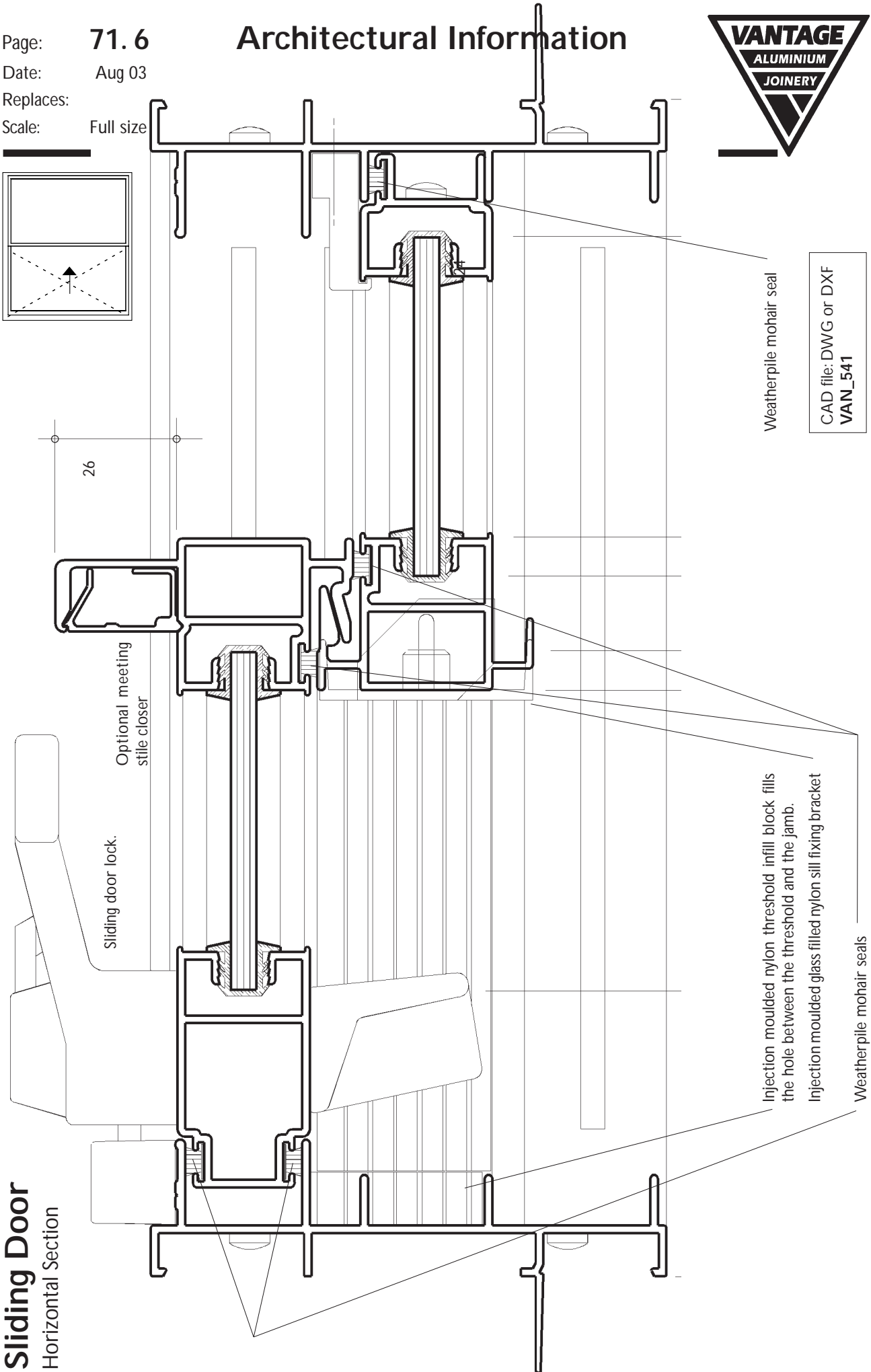
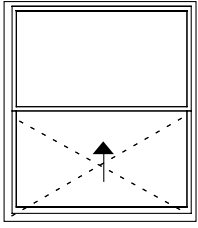

## Sliding Door Horizontal Section



# Architectural Information

## Series 541 Sliding Door

Horizontal Section through Sliding Doors

Page: 71.7

Date: May 06

Replaces: Aug 03

Scale: Quarter full size

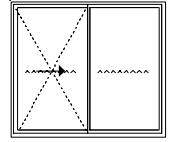
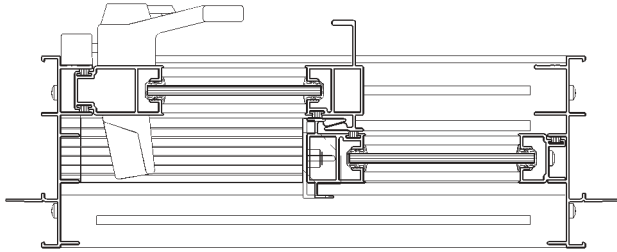

type. **XF**

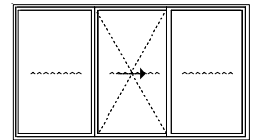
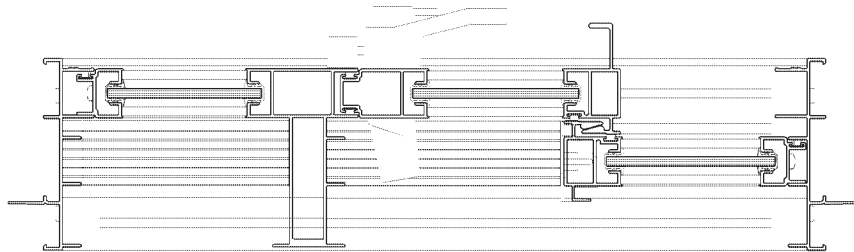

type. **FXF**

The type 'FXF' door shown above can also be assembled as type 'XFF' as shown below or 'FFX'.

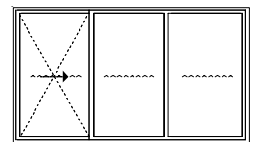
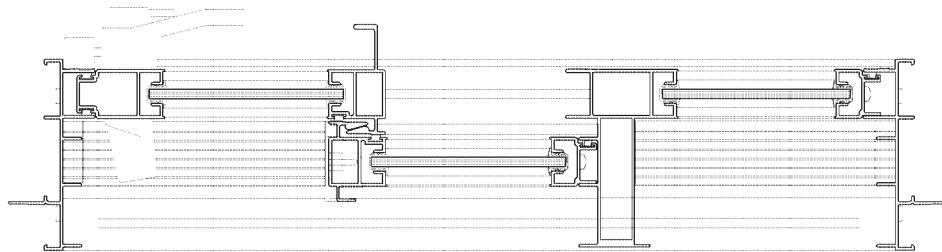

type. **XFF**

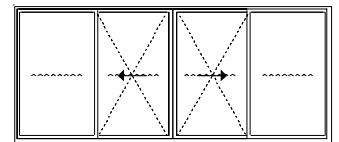

type. **FXXF**

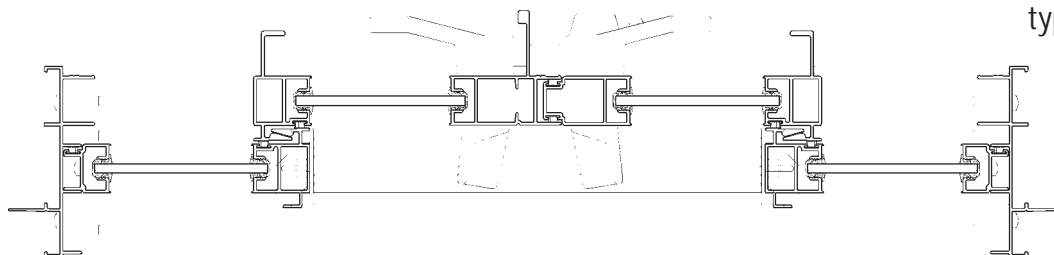

Page: 71.8  
Date: Aug 03  
Replaces:  
Scale: Full size

# Architectural Information

## Series 541 Sliding Door

Lowline Nursing Home Sill



### Nursing Home Sill

Design features:

- Suits wheel chair and walking frame access.
- Minimal ramp up.
- **Doors don't comply with AS2047 on water resistance** but the sill has been designed to drain water out of the system.
- Heavy duty tubular sill will withstand the weight of wheel chairs without crushing under the load.
- Frame will accept screen door system designed to stay on the track when opened from wheel chair height.
- Doors can be glazed with toughened or laminated grade 'A' safety glass in accordance with AS1288.
- Doors can be fitted with 68mm or 100mm chair rail if required.
- The clear door opening should be 800mm minimum.

### Builder Please Note:

- To protect these lowline sills the door must be set back from the eaves line by a minimum of 1600mm.
- The floor must be recessed as detailed to allow the sill to be flush with floor line on the inside.  
If the sill is not recessed an approved ramp will be provided on the inside by the builder.

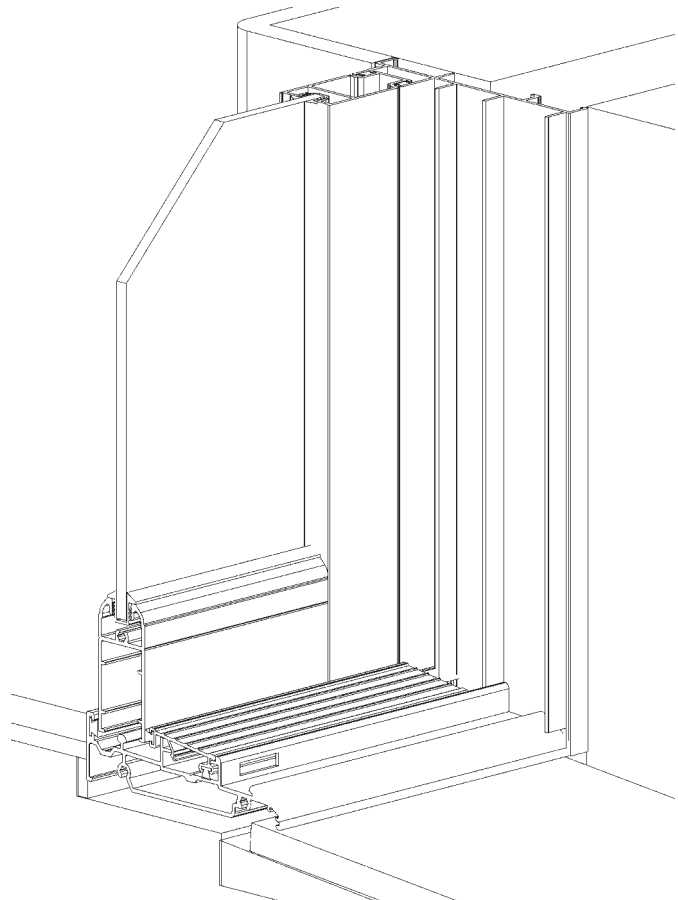

CAD file: DWG or DXF  
VAN\_541

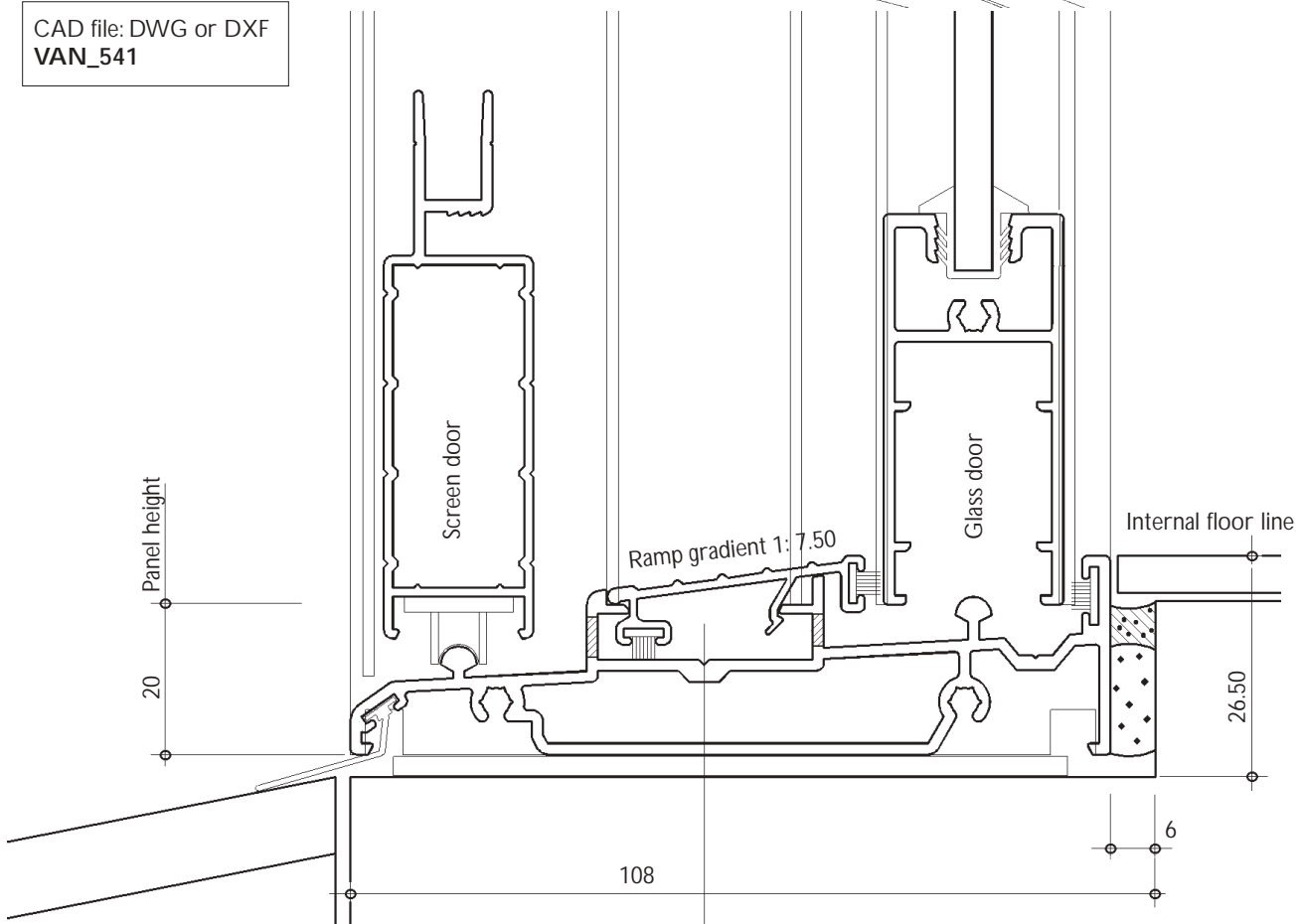



# Architectural Information

## Series 541 Sliding Door

Performance and Double Glazing

Page: **71.9**  
 Date: May 06  
 Replaces: Oct 04  
 Scale: Full size

### Meeting Stile Strength

This table shows a range of serviceability ratings (1/150) that can be achieved:

type code	Height mm	Width mm	Meeting Stiles			Panel Weight	
			Light	Medium	Heavy	5mm Glass	20mm IGU (5105)
<b>XF</b>	2100	1810	669 Pa	1021 Pa	1941 Pa	25.24 Kg	43.66 Kg
<b>XF</b>	2100	2110	585 Pa	894 Pa	1700 Pa	29.11 Kg	51.07 Kg
<b>XF</b>	2100	2410	526 Pa	803 Pa	1528 Pa	32.98 Kg	58.48 Kg

( ) Values in brackets indicate that the overall rating was limited by the highest water resistance details available on the door, as per AS2047 - 1999.

For other sizes/types refer full Pascal rating tables on web site or accompanying CD.

### Sound Reduction

A number of glass combinations have been tested in this sliding door. In all cases the opening sash was fitted with co-extruded Santoprene bulb seal on all sides.

- 4mm Toughened glass 27dB(A) RW28
- 6.38mm Laminated glass 32dB(A) RW32
- 10.38mm Laminated glass 34dB(A) RW35
- 20mm Insulating glass unit 33dB(A) RW33

SoundOUT™ (secondary glazed) sliding door is also available, refer section 58.

Go to the SoundOUT section 55 for other options.



### Thermal Transmission WERS

This window has been WERS rated. The star ratings for heating and cooling climates with various glass options can be found in the WERS section 04.

20mm Insulating glass made up of two sheets of 5mm toughened glass with 10mm air space.

16mm IGU's made up of two sheets of 4mm toughened glass with 8mm air space come with dedicated rails and stiles - no adaptor channel (as shown earlier).

Wrap around PVC glazing channel.

Double bogey roller assembly .

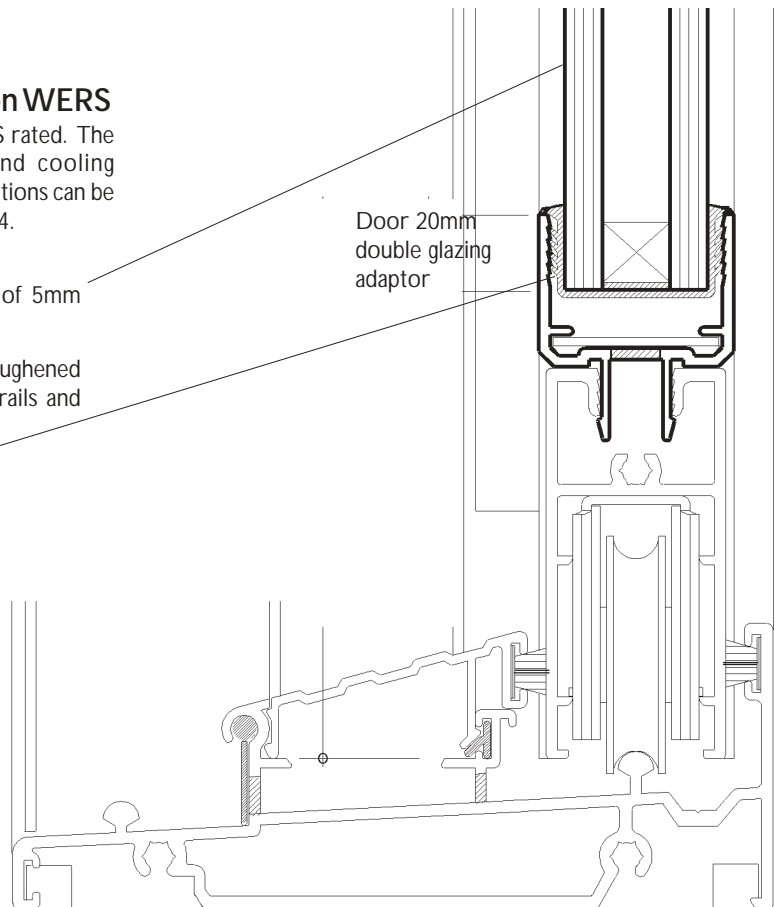
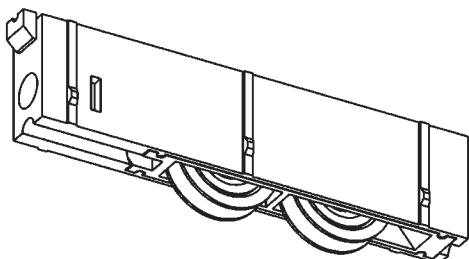

Door 20mm double glazing adaptor

Heavy duty tubular sill capable of carrying double glazed door panels without dipping between sill installation shims.

# Architectural Information

## Series 541 Sliding Door

### Couplers and FLYscreen Door

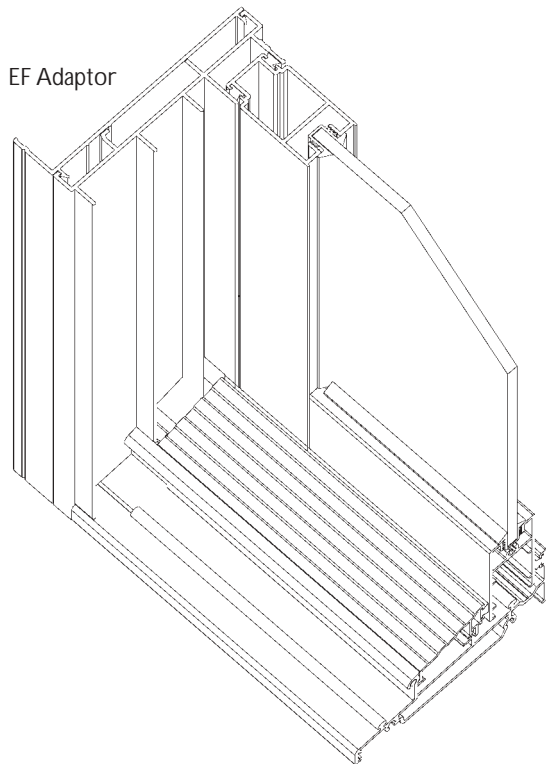

EF Adaptor

**Some of the couplers and trims offered:**

- 135° Bay coupler for 102mm windows or 102mm doors.
- 90° Corner coupler for 102mm windows or 102mm doors.
- 180° Coupler for 102mm doors.
- 'Longreach' frame extender.
- 'Homebush' frame extender (illustrated lower left).
- 'Paddington' federation trims.
- Storm moulds.
- Architraves.
- External flange adaptors (illustrated lower left).
- Flat jamb closer.

CAD file: DWG or DXF  
**VAN\_COUPLERS**

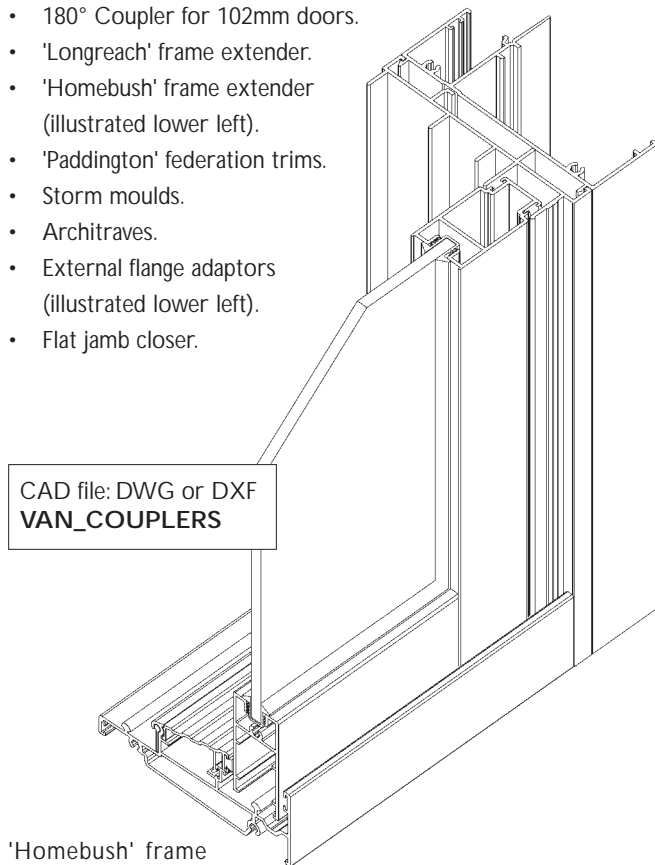

'Homebush' frame extenders on jambs.

Vantage offer a large range of snap on couplers and trims, refer section 10 for full details.

The detail below shows the custom extruded flydoor that can be fitted to Series 541 sliding doors.

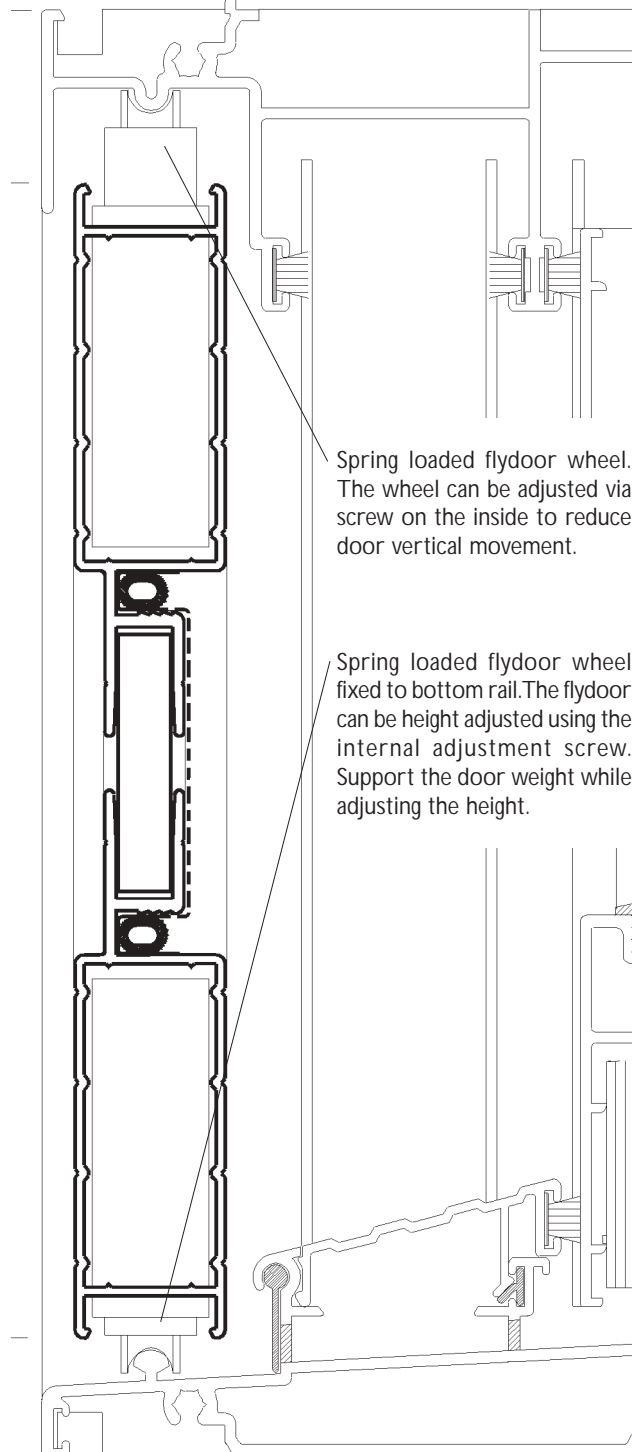

Spring loaded flydoor wheel. The wheel can be adjusted via screw on the inside to reduce door vertical movement.

Spring loaded flydoor wheel fixed to bottom rail. The flydoor can be height adjusted using the internal adjustment screw. Support the door weight while adjusting the height.

scale: full size vertical section through flydoor.



## Alternative Sliding Door

Date: May 06

High Performance Commercial Stacking Sliding Door

Replaces: Oct 04

Scale: Noted below

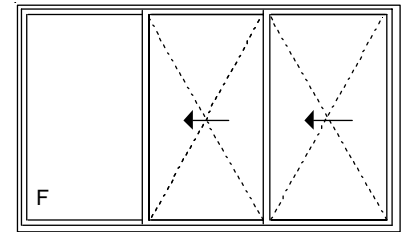
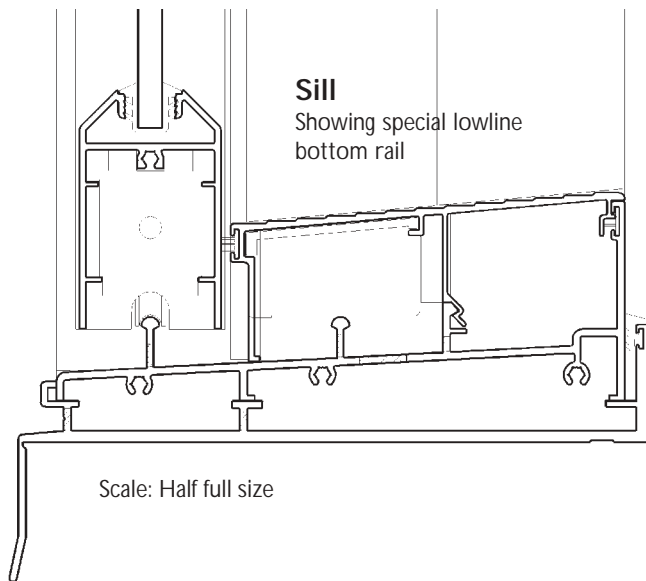

### Alternative Commercial Sliding Door

If you are looking for a stronger, higher performance, bolder sliding door consider the AWS SlideMASTER™ Series 702.

Features overview:

- 150mm Frame width.
- Can be fabricated as 'XXF' and 'FXXXXF' stacking doors.
- Very high water resistance.
- Stronger panels allow door heights up to 3000mm.
- Compatible with AWS FrontGLAZE™ shopfront framing.

Refer AWS Commercial Specifier Manual for more details.  
Coloured animated images can be seen on AWS web site:  
[awscommercial.com.au](http://awscommercial.com.au)

**Australian Registered Design.**

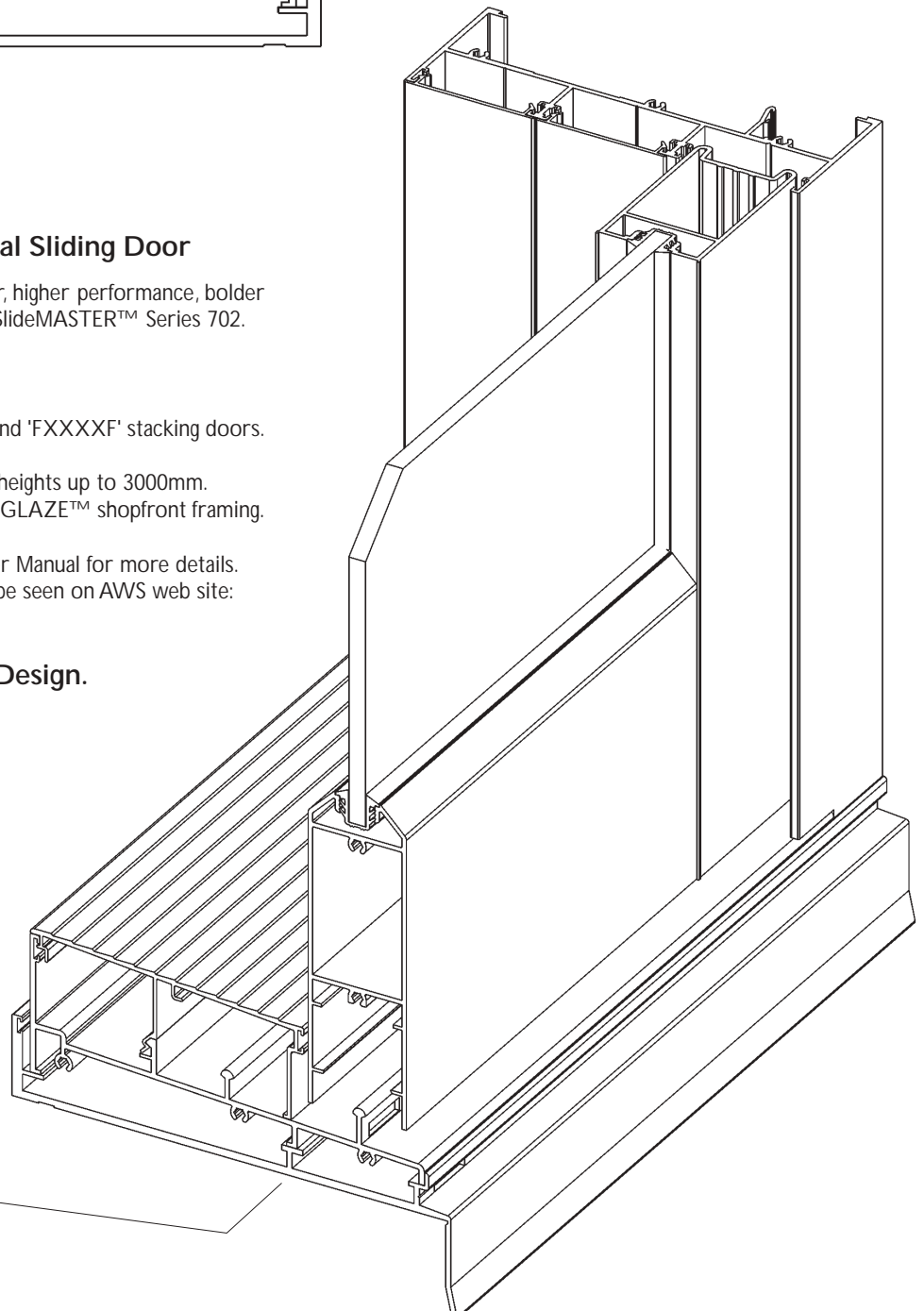

Another feature:  
The sub-sill under 150mm frame has an additional support at mid span to support the middle door panel.

Scale: Not to scale

# Architectural Information

## Alternative Sliding Door

Architectural Commercial Stacking Sliding Door

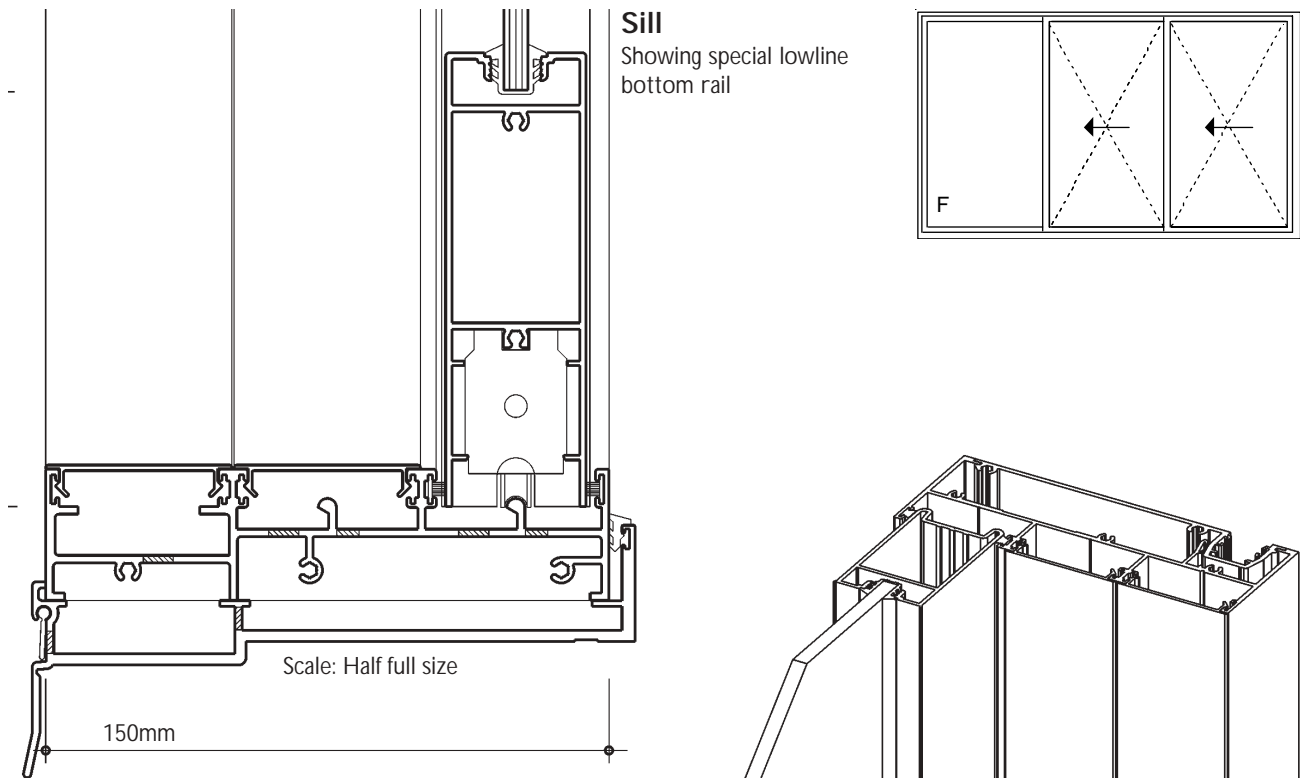

### Alternative Architectural Commercial Sliding Door

If you are looking for a stronger, bolder sliding door consider the AWS SlideMASTER™ Series 704.

#### Features overview:

- 150mm Frame width.
- Can be fabricated as 'XXF' and 'FXXXXF' stacking doors.
- Very high water resistance.
- Stronger panels allow door heights up to 3000mm.
- Compatible with AWS FrontGLAZE™ shopfront framing.

Refer AWS Commercial Specifier Manual for more details.  
Coloured animated images can be seen on AWS web site:  
[awscommercial.com.au](http://awscommercial.com.au)

### Australian Registered Design.

#### Another feature:

The sub-sill under 150mm frame has an additional support at mid span to support the middle door panel.

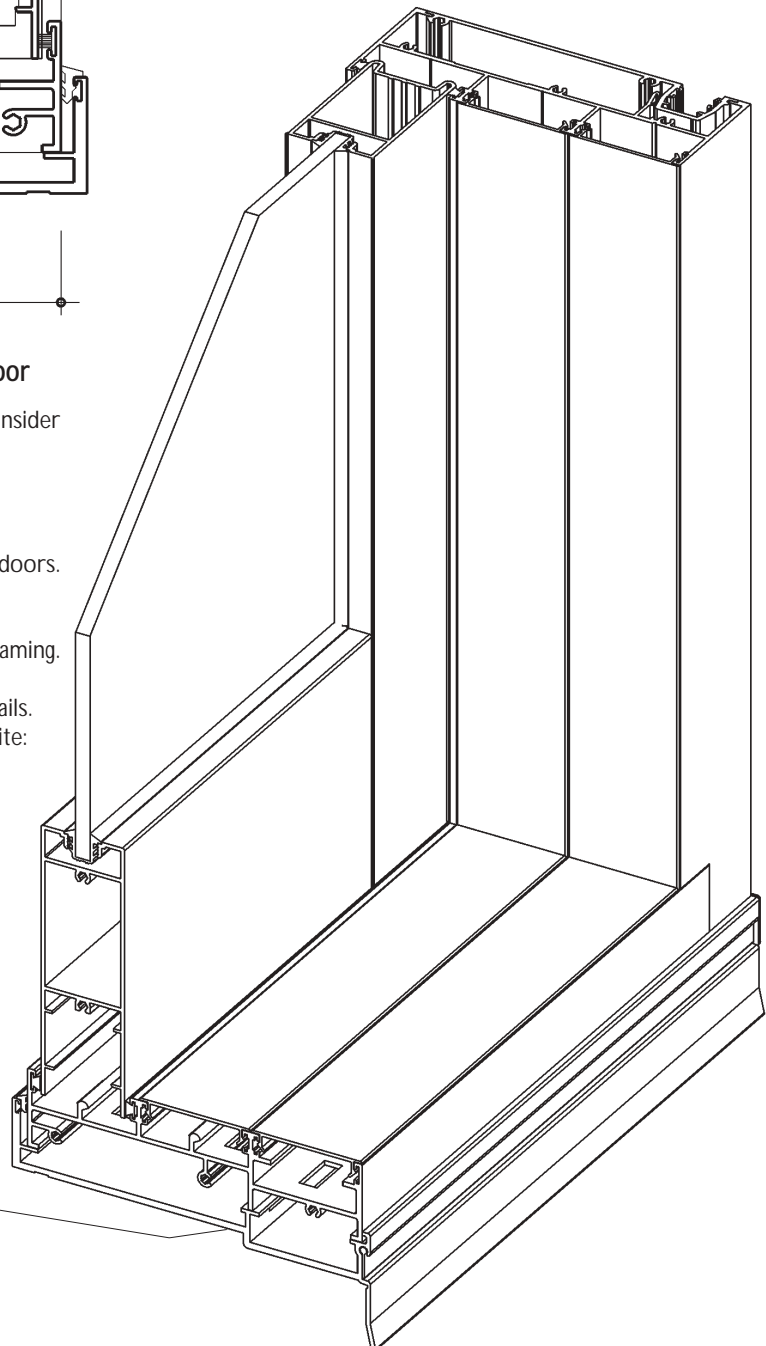

Scale: Not to scale



# Architectural Information

## Series 541 Sliding Door

Index

Page: **71.0**  
Date: Oct 04  
Replaces: Aug 03  
Scale:

---

Page	Contents
71.1	Introduction.
71.2	Glazing options.
71.3	Check list.
71.4	Vertical section through opening panel.
71.5	High performance sill & Lock options.
71.6	Horizontal section.
71.7	Horizontal section through sliding doors.
71.8	Lowline nursing home sill.
71.9	Performance and double glazing.
71.10	Couplers and flyscreen door.
71.11	Alternative commercial sliding door.
71.12	Alternative commercial sliding door.

Series 541 Sliding door internal view  
(Not to scale)

